

# ALUMINUM & SECURITY STORM DOORS 2019

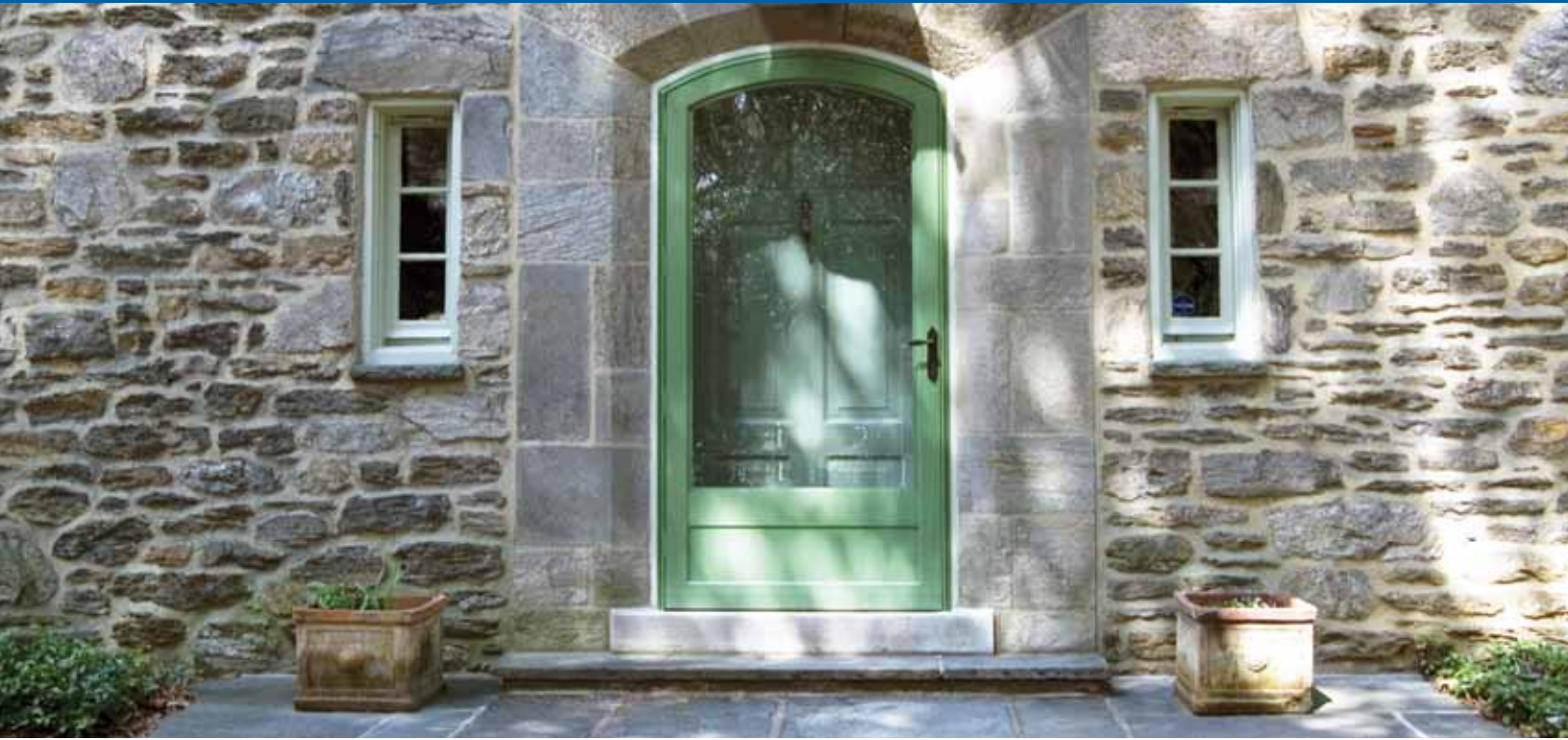

# TABLE OF CONTENTS

## ALUMINUM STORM DOORS

- 4** ELITE™ STORM DOORS - 600 SERIES
- 5** ARCH TOP / SELF-STORING - 600 SERIES
- 6** PET DOOR - 600 SERIES
- 7** PHOTO GALLERY
- 8-9** STORM DOOR FEATURES
- 10** CLASSIC™ STORM DOORS - 700 SERIES
- 11** SELF-STORING / PET DOOR - 700 SERIES

## ALUMINUM STORM DOOR MEASUREMENTS

For door styles below, glass size is fixed for all door heights up to 85"  
The bottom panel is variable.



HM 601  
HM 701

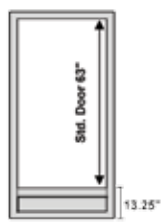

HM 602  
HM 702  
This is a recessed panel

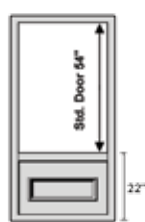

HM 603\*  
HM 703\*

Measurement for typical  
door size is 36" x 80"

The HM-603/703 panel  
is always raised trim.  
It cannot be  
embossed.

### SELF STORING GLASS

The glass opening for the styles below are fixed.  
The bottom panel is variable.

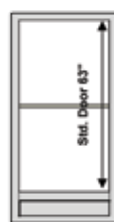

HM 607  
HM 707

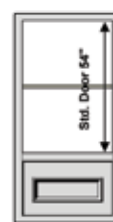

HM 608\*  
HM 708\*

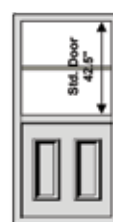

HM 610  
HM 710

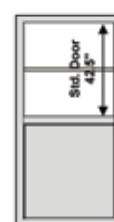

HM 613  
HM 713

The HM 608/708  
panel is always  
raised trim. It  
cannot be  
embossed.

The panel designs of HM 610, and 710  
are embossed if door is 30" or wider.

Doors under 30" will have raised trim

The HM 613/713  
has a flush panel  
for doggie door

The top glass sizes for the styles below are fixed for door heights up to and including 85".  
The glass size will increase for doors over 85" in height.

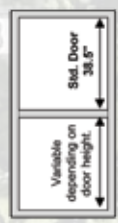

HM 604  
HM 704

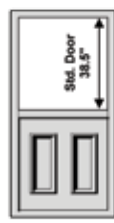

HM 606  
HM 706



HM 612  
HM 712

HM-601	P. 4	HM-703	P. 10	HS-600	P. 4
HM-602	P. 4	HM-704	P. 10	HS-601	P. 4
HM-603	P. 4	HM-706	P. 10	HS-602	P. 4
HM-604	P. 4	HM-707	P. 11	HS-603	P. 4
HM-606	P. 4	HM-708	P. 11	HS-604	P. 4
HM-607	P. 5	HM-710	P. 11	HS-605	P. 4
HM-608	P. 5	HM-712	P. 11	HS-700	P. 10
HM-610	P. 5	HM-713	P. 11	HS-701	P. 10
HM-612	P. 6			HS-702	P. 10
HM-613	P. 6			HS-703	P. 10
HM-701	P. 10			HS-704	P. 10
HM-702	P. 10			HS-705	P. 10

## HARDWARE

### 34 ALUMINUM STORM DOOR LOCK OPTIONS

Cover Photos: Aluminum Storm Door - HM-602 Camber Top  
Security Storm Door - HM-926 New Castle



# SAFEGUARD™ SECURITY STORM DOORS

**12-15** LASER CUT SERIES

**16-19** CONTEMPORARY SERIES

**20-21** FORGED SERIES

**22-23** MODERN SERIES

**24** SUNSHINE SERIES

**25** FULL VIEW SERIES

**26-31** TRADITIONAL SERIES

**32** VALUE LINE

**33** ARCH TOP / FEATURES

## SECURITY DOOR MEASUREMENTS

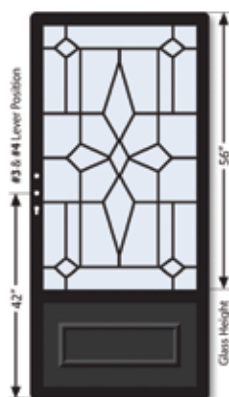

Typical 36" x 80" Door Opening

- Center of lever for #3 & #4 Handlesets is positioned 42" from the bottom of the door.
- Center of handle for #1, #2 & #5 Handlesets is positioned 37 1/2" from the top of the door. Doors over 87" will be adjusted accordingly.
- Exact door blank size for standard 36" x 80" opening is 35 1/4" x 78 3/4"
- Main Security Door Frame is constructed of 2" x 1" 16 gauge Steel Tubing

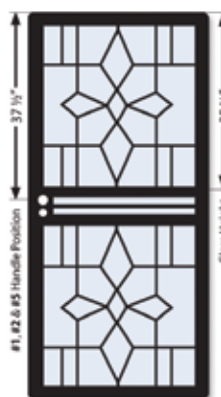

HM-102	P. 28	HM-134	P. 31	HM-160	P. 22	HM-906	P. 12	HM-952	P. 22
HM-102-RF	P. 28	HM-134-RF	P. 31	HM-160-RF	P. 22	HM-908	P. 12	HM-954	P. 18
HM-104	P. 28	HM-135	P. 31	HM-163	P. 27	HM-910	P. 13	HM-956	P. 18
HM-104-RF	P. 28	HM-135-RF	P. 31	HM-163-RF	P. 27	HM-912	P. 13	HM-958	P. 19
HM-106	P. 28	HM-137	P. 30	HM-167	P. 26	HM-914	P. 13	HM-960	P. 19
HM-106-RF	P. 28	HM-137-RF	P. 30	HM-167-RF	P. 26	HM-916	P. 14	HM-968	P. 27
HM-111	P. 26	HM-138	P. 30	HM-180	P. 20	HM-918	P. 14	HM-968-RF	P. 27
HM-111-RF	P. 26	HM-138-RF	P. 30	HM-180-RF	P. 20	HM-920	P. 14	HM-970	P. 23
HM-112	P. 26	HM-139	P. 30	HM-181	P. 20	HM-922	P. 14	HM-971	P. 23
HM-112-RF	P. 26	HM-139-RF	P. 30	HM-181-RF	P. 20	HM-924	P. 14	HM-972	P. 23
HM-113	P. 24	HM-140	P. 30	HM-182	P. 20	HM-926	P. 14	HM-972-RF	P. 23
HM-114	P. 24	HM-140-RF	P. 30	HM-182-RF	P. 20	HM-928	P. 15	HM-974	P. 23
HM-123	P. 29	HM-141	P. 24	HM-183	P. 20	HM-930	P. 15	HM-975	P. 23
HM-123-RF	P. 29	HM-141-RF	P. 24	HM-183-RF	P. 20	HM-932	P. 15	HM-976	P. 23
HM-124	P. 29	HME-142	P. 32	HM-184	P. 24	HM-934	P. 15	HM-976-RF	P. 23
HM-124-RF	P. 29	HME-143	P. 32	HM-185	P. 24	HM-936	P. 15		
HM-125	P. 29	HME-144	P. 32	HM-187	P. 24	HM-938	P. 15		
HM-125-RF	P. 29	HME-145	P. 32	HM-213	P. 24	HM-940	P. 16		
HM-126	P. 29	HME-146	P. 32	HM-213-RF	P. 24	HM-942	P. 16		
HM-126-RF	P. 29	HME-147	P. 32	HM-313	P. 24	HM-946	P. 17		
HM-128	P. 28	HM-156	P. 26	HM-313-RF	P. 24	HM-948	P. 17		
HM-128-RF	P. 28	HM-156-RF	P. 26	HM-314	P. 24	HM-950	P. 22		
HM-133	P. 31	HM-158	P. 22	HM-902	P. 12	HM-951	P. 22		
HM-133-RF	P. 31	HM-159	P. 22	HM-904	P. 12	HM-951-RF	P. 22		

## HARDWARE

**35** SECURITY STORM LOCK OPTIONS / HARDWARE OPTIONS / POWDERCOAT

**BACK COVER** HME 874LA DOOR, HSE 868LA SIDELITES AND HT 800LA TRANSOM

pg = PRICE BOOK PAGE

# ELITE™ STORM DOOR STYLES - 600 SERIES



\* HM-601  
pg. 3

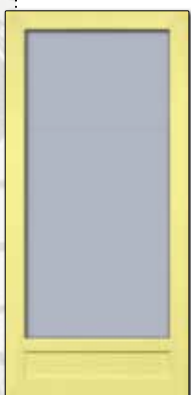

\* HM-602  
pg. 3



\* HM-603  
pg. 3



HM-604  
pg. 3

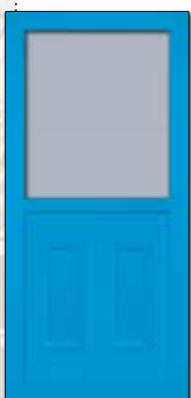

HM-606  
pg. 3

HM-601 Double Storm Door ▼



HM-606 Storm Door ▼

pg. 3

HMT's Elite™ aluminum storm doors balance form and function. Designed to protect your entry door from the elements, they are heavy duty and built to last. With 13 door styles and 24 matching entry door colors to choose from, your preference is sure to be met. Whether it is a traditional full view; our ergonomic self storing; or our archtop storm door you get what you want.

All glass is tempered safety glass. It is held in place using our exclusive cam lock system giving a secure fit. Choose from standard clear glass or Low-e glass.

## \* FULL SCREEN WITHOUT CENTER BAR

Enjoy the beauty of your entry door glass without the obstruction of a center support bar on the storm door screen. The HM-601, 602 and 603 have a 1 ½" heavy extrusion aluminum screen frame eliminating the center bar.

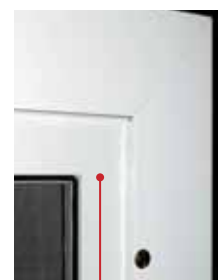

1 ½" Heavy Extrusion  
Aluminum Screen frame



HS-600  
pg. 6



HS-601  
pg. 6



HS-602  
pg. 6



HS-603  
pg. 6



HS-604  
pg. 6



HS-605  
pg. 6



pg. 3

\* indicates screens without center bar

# ARCH TOP ALUMINUM STORM DOORS

Custom made to fit your entryway, our elite aluminum storm doors are available in 5 arch top shapes. They are pre-formed to fit your opening. The glass is held in place using our cam lock system giving a secure fit. Screens for 601, 602, 603 have center support bar.

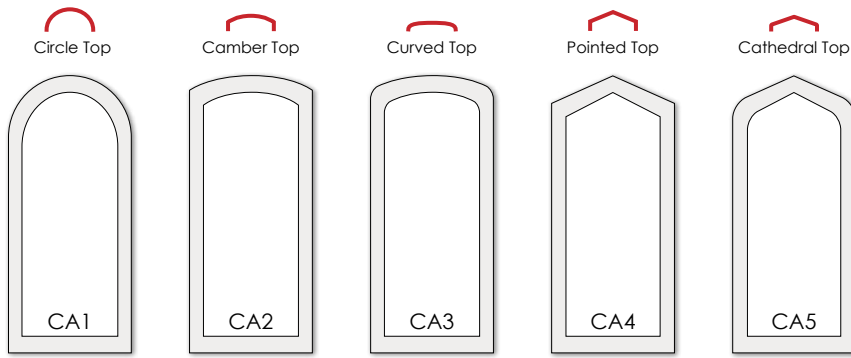

Arch top available for 601, 602, 603, 604, 606, 612

HM-604 Circle Top Storm Door



## SELF-STORING GLASS - 600 SERIES

HM-607 Self-Storing Storm Door

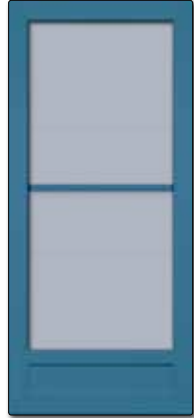

HM-607  
pg. 3



HM-608  
pg. 3



HM-610  
pg. 3

- Two moveable glass panels operate independently from top, bottom or both
- Glass frame designed to stay in track
- Nylon guide for smooth operation
- Removable screen
- Easy touch sliding glass lock







pg. 3

**HM-604 Cathedral Top Storm Door** ▲



pg. 3

**HM-601 Double Storm Doors** ▲

## PET DOOR

We have not forgotten your best friends. A pet door can be added to HM-612 and HM-613 flush bottom doors.

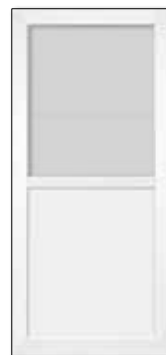

**HM-612**  
pg. 3

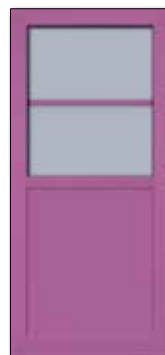

**HM-613 - Self-Storing**  
pg. 3



pg. 3

HM-608 Self-Storing Storm Door ▲

HM-601 Storm Door ▼

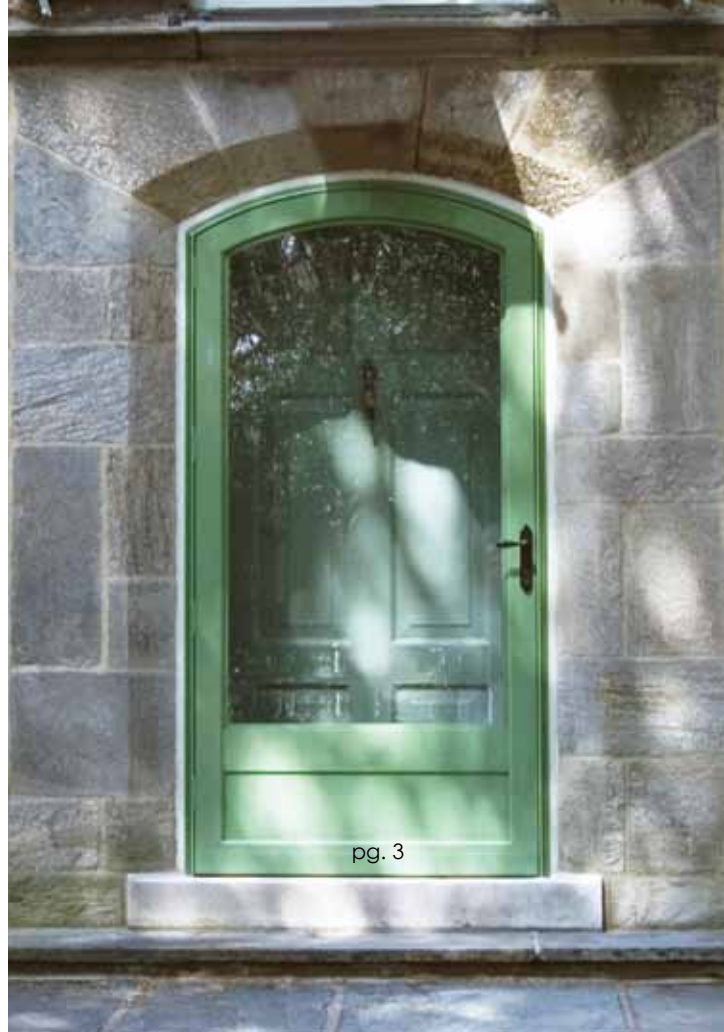

pg. 3

HM-602 Camber Top Storm Door ▲

HM-608 Self-Storing Circle Top Storm Door ▼



pg. 3



pg. 3



# ELITE™ ALUMINUM STORM DOOR FEATURES

## 600 SERIES MAX SIZE 48 X 96

- Available in 5 arch top shapes
- 24 powdercoat colors to match entry door paint colors (included) and over 200 custom RAL colors (optional)
- Rigid 3 1/2" Extruded Aluminum Door Frame
- 5/8" Foam Insulation in all doors with a bottom panel
- Extruded Aluminum Corner Gusset System
- Galvannealed Steel Bottom Panel - painted same color as door
- 3" Aluminum Bottom Expander - painted same color as door
- Bottom Sweep
- Matching Pump



24 powdercoat colors to match entry door paint colors (included) and over 200 custom RAL colors (optional)

5/8" Foam Insulation in all doors with a bottom panel

Galvannealed Steel Bottom Panel - painted same color as door

3" Aluminum Bottom Expander - painted same color as door

Bottom Sweep

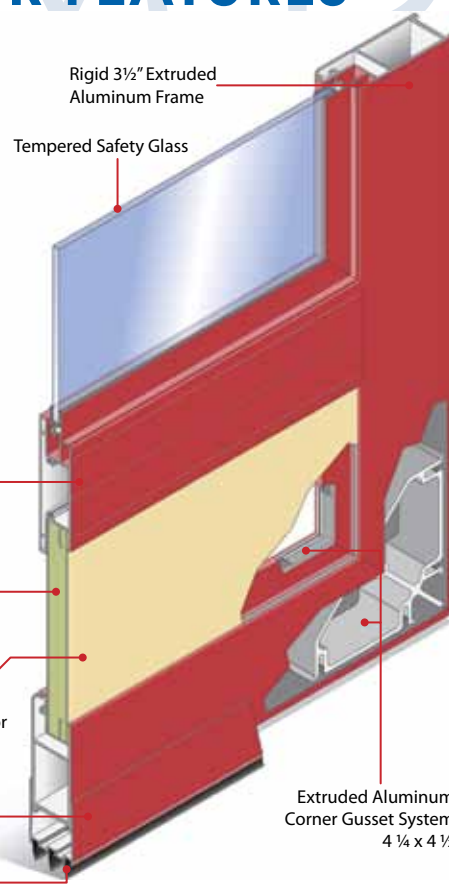

Extruded Aluminum Corner Gusset System  
4 1/4 x 4 1/2

# CLASSIC™ ALUMINUM STORM DOOR FEATURES

## 700 SERIES MAX SIZE 37 X 85

- Not available in arch tops
- White powdercoat color (standard)
- 23 powdercoat colors to match entry door paint colors (optional)
- Rigid 3" Extruded Aluminum Door Frame
- 5/8" Foam Insulation in all doors with a bottom panel
- Extruded Aluminum Corner Gusset System
- Galvannealed Steel Bottom Panel - painted same color as door
- 3" Aluminum Bottom Expander - painted same color as door
- Bottom Sweep
- Matching Pump

White powdercoat color (Standard) and 24 powdercoat colors to match entry door paint colors (Optional)

5/8" Foam Insulation in all doors with a bottom panel

Galvannealed Steel Bottom Panel - painted same color as door

3" Aluminum Bottom Expander - painted same color as door

Bottom Sweep

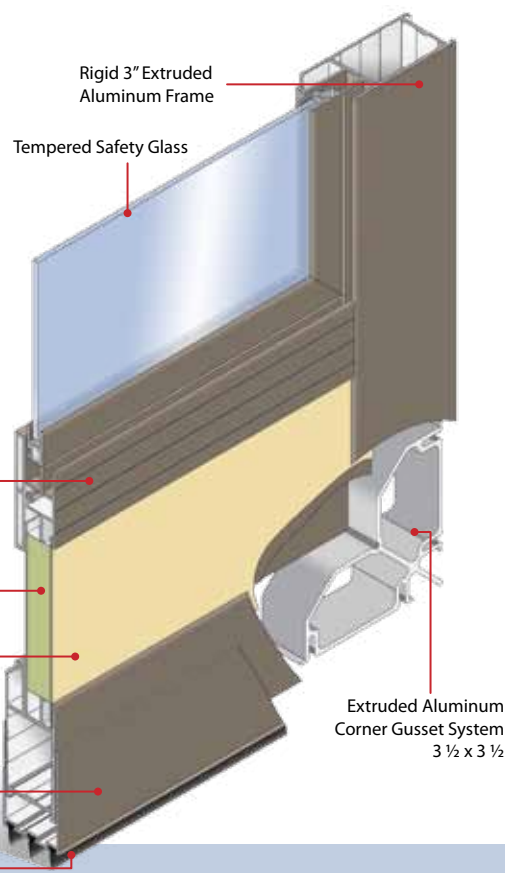

Extruded Aluminum Corner Gusset System  
3 1/2 x 3 1/2



# ALUMINUM STORM DOOR FEATURES FOR 600 & 700 SERIES

## Aluminum Extruded Hinges

Continuous extruded hinges, manufactured exclusively by HMI, surpass the quality and durability of anything else offered on the market. Extending from top to bottom, and reinforced with a 1/4" plated steel rod and nylon bushings, our extruded hinges will never sag or warp from the weight of the door. (Painted same color as door.)



## Cam Lock System - No More Clips!

Offered exclusively by HMI, the Cam Lock System is one of the Elite™ and Classic™ Storm Doors innovations. It is free of loose parts and accessories, giving the homeowner problem free operation. All the hardware is hidden inside the door frame. One quick turn to loosen and another one to tighten! All you need is a penny.



## OPTIONAL

### Expandable Frame - Optional

HMI's patented expandable frame helps make installation a snap and the appearance beautiful. It allows for adjustments up to 3/8". Made of extruded aluminum it creates a perfectly level opening to fit the storm door.

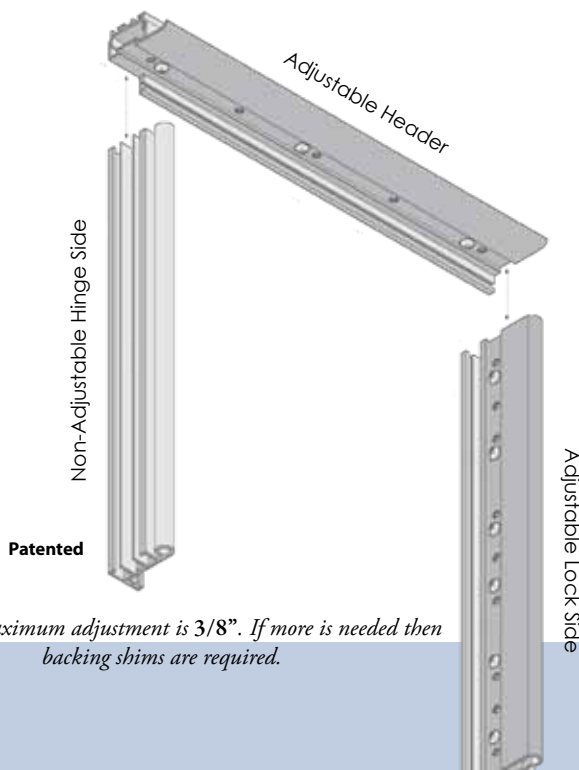

*Note: The maximum adjustment is 3/8". If more is needed then backing shims are required.*

### Heat Ventilation System - Optional

Occasionally, heat becomes trapped in between the storm door and entry door leading to condensation build-up or damage to the entry door's paint finish. With the help of our Heat Ventilation System, the hot air is given a path to exit. On the top edge of the storm door are a series of holes, and a vent cap is installed on the face of the door. The vent can be opened during the summer and closed during the winter.

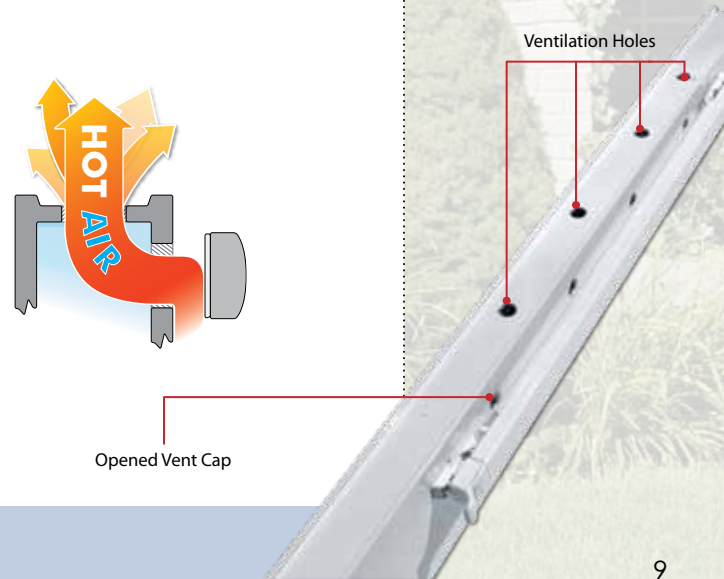

# CLASSIC™ STORM DOOR STYLES - 700 SERIES

MAX SIZE 37 X 85



HM-701  
pg. 5

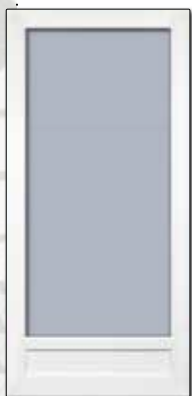

HM-702  
pg. 5



HM-703  
pg. 5

Screen for HM-701, HM-702 and HM-703 has a horizontal stabilizer bar.



HM-704  
pg. 5



HM-706  
pg. 5

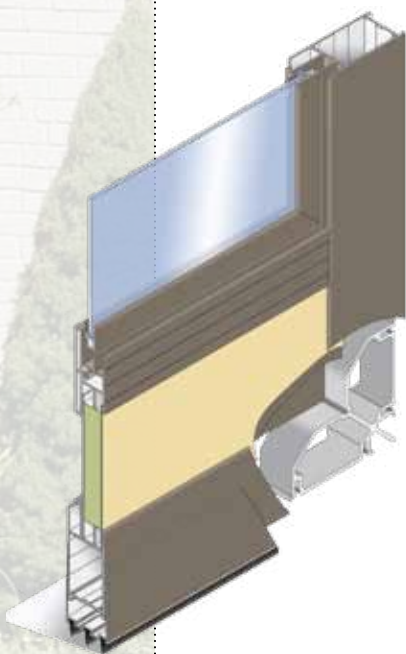

Our Classic™ storm doors give the value you are looking for, without sacrificing quality.

Designed to protect your entry door from the elements, they are heavy duty and built to last. Whether it is a traditional full view or ergonomic self-storing storm door you get what you want.

The glass is held in place using our patented cam lock system giving a secure fit. All glass is tempered safety glass.

Available in 13 door styles, white is standard with 23 optional powdercoat colors matching the entry door.

HM-702 Storm Door ▼



pg. 5

Arch tops are not available for 700 Series

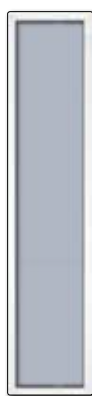

HS-700  
pg. 6



HS-701  
pg. 6

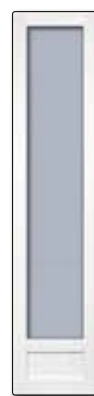

HS-702  
pg. 6



HS-703  
pg. 6

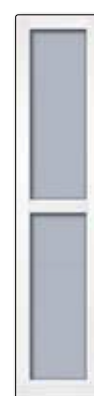

HS-704  
pg. 6



HS-705  
pg. 6



# SELF-STORING GLASS - 700 SERIES

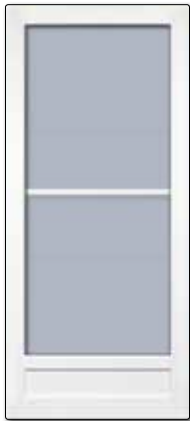

HM-707  
pg. 5



HM-708  
pg. 5



HM-710  
pg. 5

## Standard Color



White

For additional (optional) powdercoat colors see color chart on inside back cover

- Two moveable glass panels operate independently from top, bottom or both
- Glass frame designed to stay in track
- Nylon guide for smooth operation
- Removable screen
- Easy touch sliding glass lock



## PET DOOR

We have not forgotten your best friends. A pet door can be added to HM-712 and HM-713 flush bottom doors.

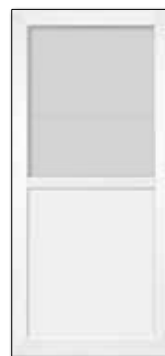

HM-712  
pg. 5

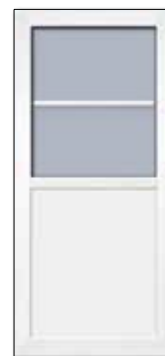

HM-713 - Self-Storing  
pg. 5

## SAFEGUARD™ SECURITY DOORS

With an HMI SafeGuard™ security storm door you don't have to sacrifice style for security. The heavy 16 gauge welded steel door frames give you the security you seek, and our designs give you the beauty you desire.

Every door is custom made to fit your entryway. Whether it is our traditional; modern; sunshine; forged or laser cut series there is a design that is perfect for your home.

There are 5 arch top shapes to choose from to fit your architectural needs. Most doors are available in arch top styles.

Black is standard with 23 optional powder coats matching our entry door colors.



HM-902 Crystal ▲

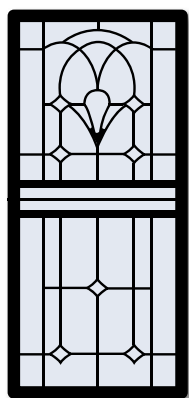

HM-902  
Crystal  
pg. 17

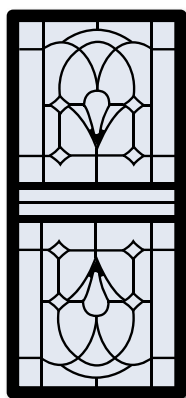

HM-904  
Eastern  
pg. 17

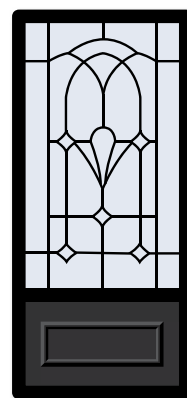

HM-906  
Queen  
pg. 17

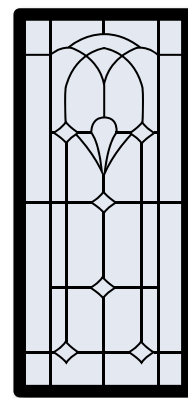

HM-908  
Glamour  
pg. 17





HM-914 Windsor ▲

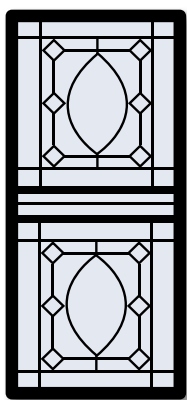

HM-910  
Allure  
pg. 17

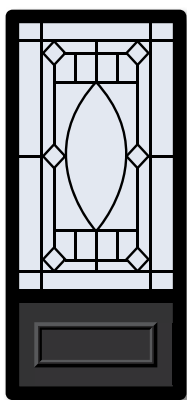

HM-912  
Mystique  
pg. 18

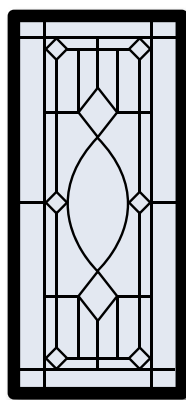

HM-914  
Windsor  
pg. 18

# LASER CUT SERIES



HM-918 Verona ▲



HM-926 New Castle ▲

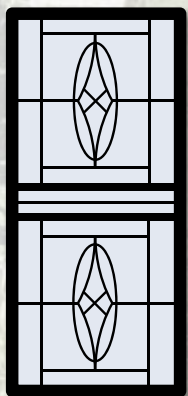

HM-916  
Alys  
pg. 18

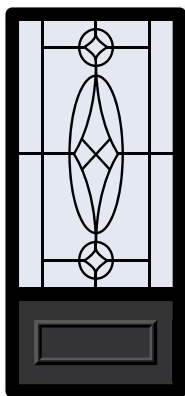

HM-918  
Verona  
pg. 18

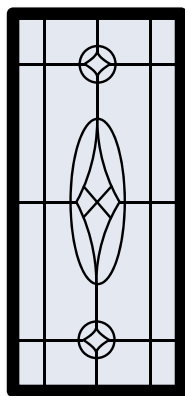

HM-920  
Cambridge  
pg. 18

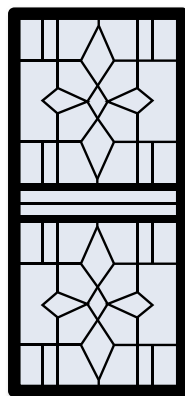

HM-922  
Templar  
pg. 19

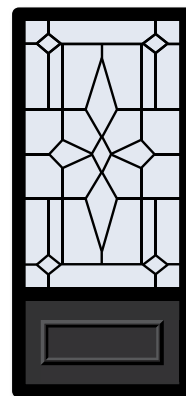

HM-924  
Horizon  
pg. 19

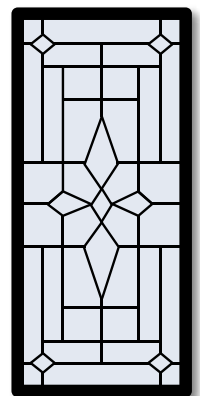

HM-926  
New Castle  
pg. 19





HM-930 Lotus ▲



HM-938 Serenity ▲

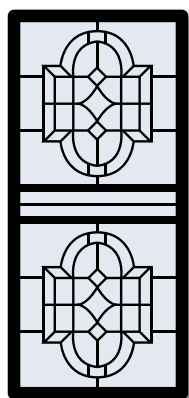

HM-928  
Paragon  
pg. 19

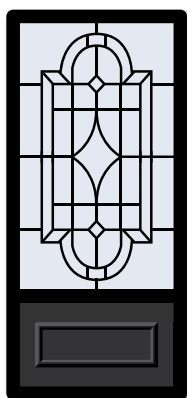

HM-930  
Lotus  
pg. 19

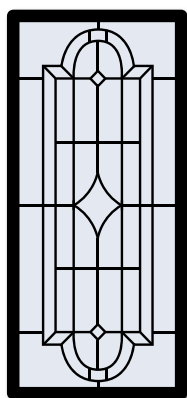

HM-932  
Vintage  
pg. 20

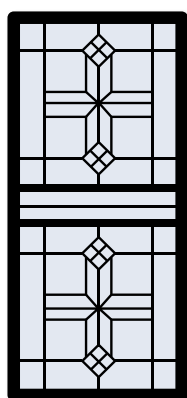

HM-934  
Heritage  
pg. 20

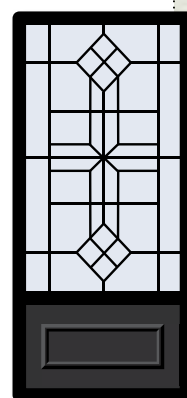

HM-936  
Wyngate  
pg. 20

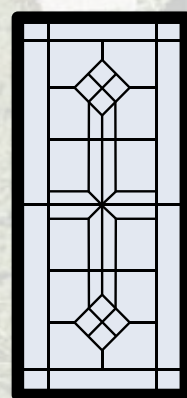

HM-938  
Serenity  
pg. 20

# CONTEMPORARY SERIES



HM-940 Cardiff ▲



HM-942 Bristol ▲

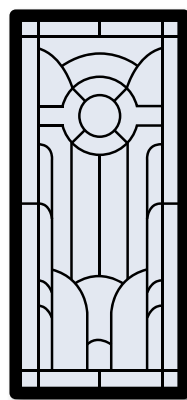

HM-940  
Cardiff  
pg. 20

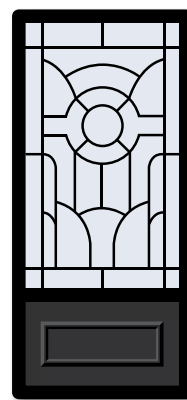

HM-942  
Bristol  
pg. 21





pg. 21

HM-946 Milan ▲



pg. 21

HM-948 Tokyo ▲

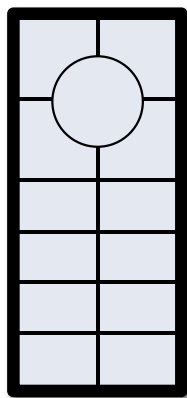

HM-946  
Milan  
pg. 21

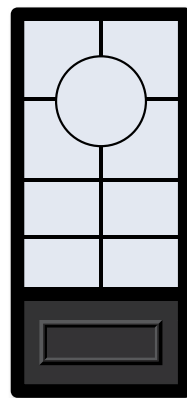

HM-948  
Tokyo  
pg. 21

# CONTEMPORARY SERIES



HM-954 Brooklyn ▲



HM-956 Boston ▲

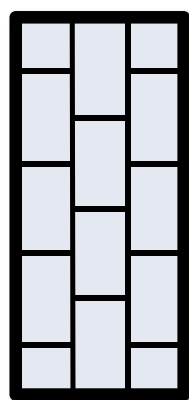

HM-954  
Brooklyn  
pg. 22

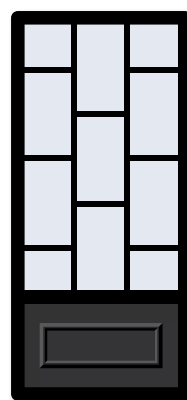

HM-956  
Boston  
pg. 22





pg. 22

HM-958 Madrid ▲



pg. 22

HM-960 London ▲

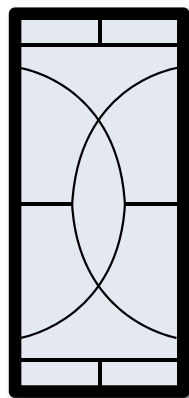

HM-958  
Madrid  
pg. 22

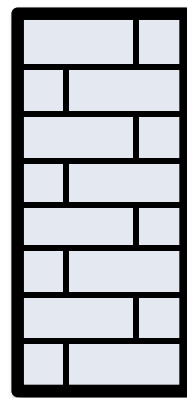

HM-960  
London  
pg. 22

# FORGED SERIES

# SAFEGUARD



pg. 23

HM-180 Rometto ▲

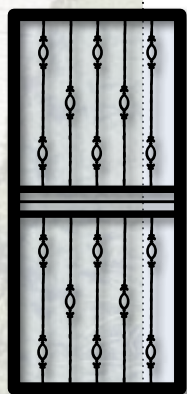

HM-180  
Rometto  
pg. 23



HM-180-R



HM-180-F



Design Detail



pg. 23

HM-181 Cascade ▲



HM-181-R



HM-181-F

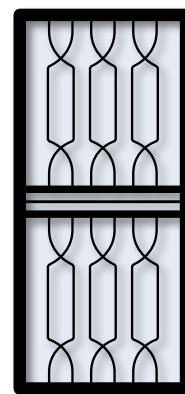

HM-181  
Cascade  
pg. 23





pg. 23

HM-182 Olympia ▲

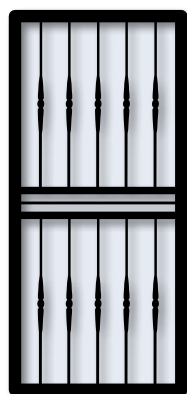

HM-182  
Olympia  
pg. 23



HM-182-R



HM-182-F



Design Detail



pg. 25

HM-183 Ridgeway ▲

HMI's Forged Series Doors are the highest quality Security Doors available. Not only are the rails constructed of steel tubing, but the design elements are made of solid forged steel and welded to the door.



HM-183-R



HM-183-F

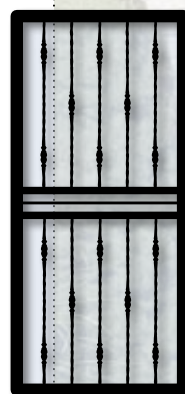

HM-183  
Ridgeway  
pg. 25



# MODERN SERIES



HM-951 Manhattan ▲



HM-159 Eastern ▲



HM-950  
Queens  
pg. 21

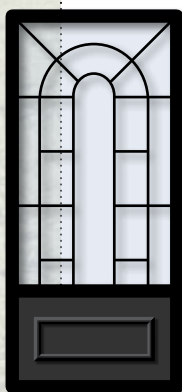

HM-952  
Yonkers  
pg. 21

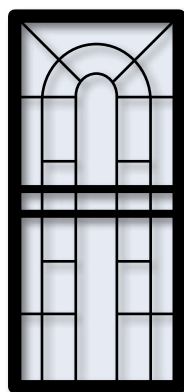

HM-951  
Manhattan  
pg. 21



HM-951-R



HM-951-F

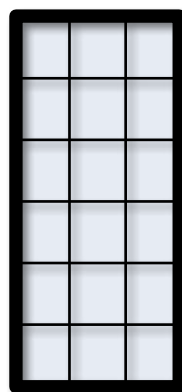

HM-158  
Palladian  
pg. 27

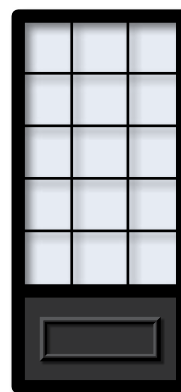

HM-159  
Eastern  
pg. 27

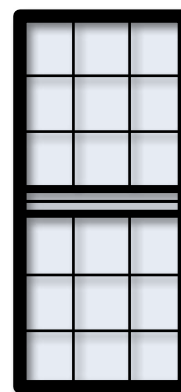

HM-160  
Maryland  
pg. 27



HM-160-R



HM-160-F



CA1



CA2



CA3



CA4



CA5





HM-970 Victoria ▲



HM-975 Avant-garde ▲

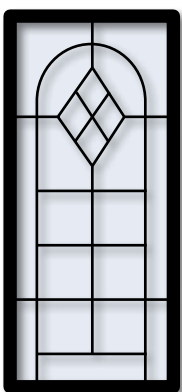

HM-970  
Victoria  
pg. 28

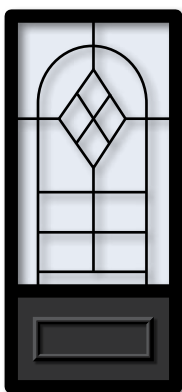

HM-971  
Everett  
pg. 28

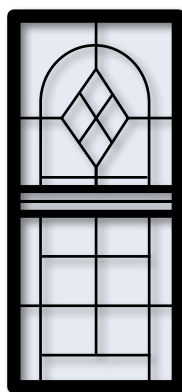

HM-972  
Riviera  
pg. 28



HM-972-R



HM-972-F

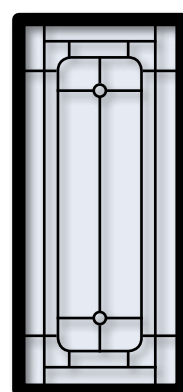

HM-974  
Ventura  
pg. 28

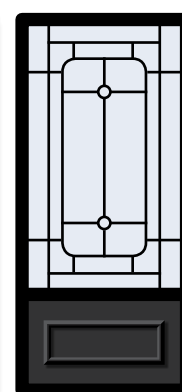

HM-975  
Avant-garde  
pg. 29

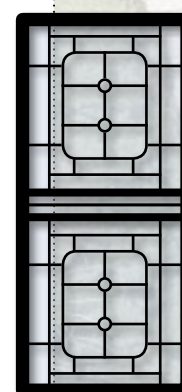

HM-976  
Gloster  
pg. 29



HM-976-R



HM-976-F

# SUNSHINE SERIES

# SAFEGUARD



HM-213 Sunburst ▲

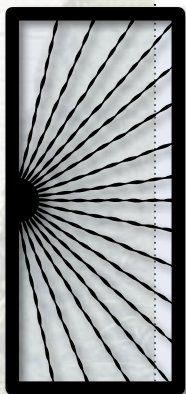

HM-113  
Sunbeam  
pg. 30

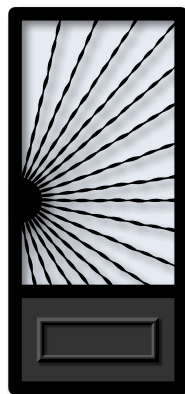

HM-314  
Sunshine  
pg. 29

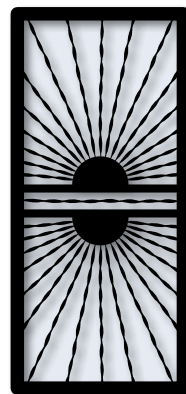

HM-213  
Sunburst  
pg. 30



HM-213-R



HM-213-F

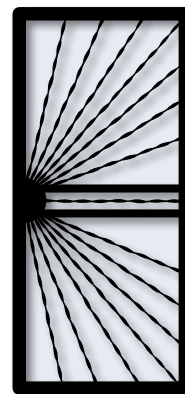

HM-313  
Sunset  
pg. 30



HM-313-R



HM-313-F



CA1



CA2



CA3



CA4



CA5

FOR MATCHING SIDELITES REFER TO PRICE BOOK



## FULL VIEW SERIES



pg. 31

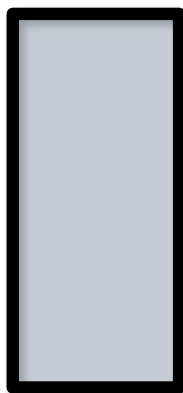

**HM-114**  
Clear View  
pg. 31



**HM-187**  
Plain View  
pg. 31



**HM-141**  
Philly  
pg. 31



**HM-141-R**



**HM-141-F**

◀ **HM-114** Clear View with Mailslot

US Postal regulations require mail slots to be no less than 30" from the ground.

Not available with Arch Top

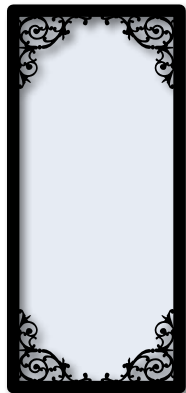

**HM-184**  
Candela\*  
pg. 30

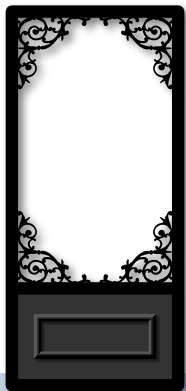

**HM-185**  
Florence\*  
pg. 31

**HM-185** Florence ▼ Arch Top Not Available

\* Not available in zinc plating for shoreline



pg. 31



# TRADITIONAL SERIES



HM-111 Macao (with Cathedral Arch Top) ▲



HM-156 Tea Garden ▲

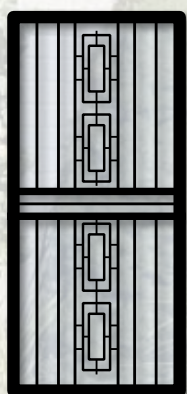

HM-111  
Macao\*  
pg. 32

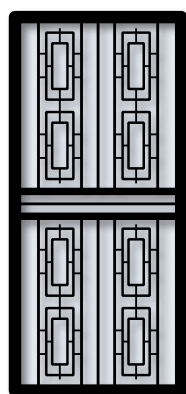
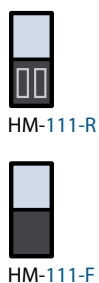

HM-112  
Oriental\*  
pg. 32

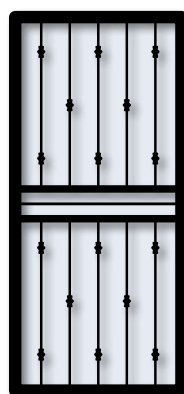
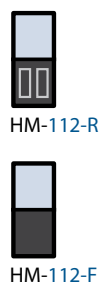

HM-167  
Neptune\*  
pg. 32

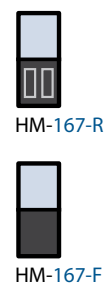

HM-167 Design Detail

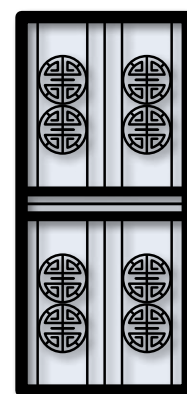

HM-156  
Tea Garden\*  
pg. 33

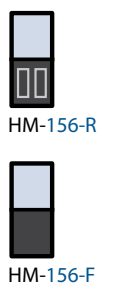





pg. 33

HM-163 Versailles ▲



pg. 32

HM-167 Neptune ▲

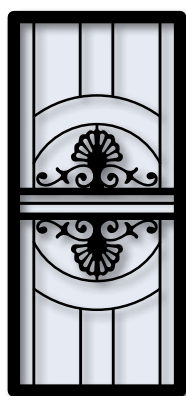

HM-163-R



HM-163-F

HM-163  
Versailles\*  
pg. 33

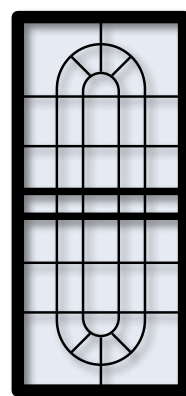

HM-968-R



HM-968-F

HM-968  
Modern\*  
pg. 32



# TRADITIONAL SERIES

MAX HEIGHT 87"



HM-102-R Tiara (with Circle Top) ▲

HM-106 Classic ▲



HM-102-R



HM-102-F



HM-104-R



HM-104-F

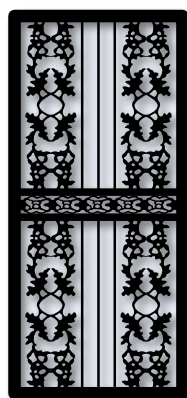

HM-106-R



HM-106-F



HM-128-R



HM-128-F

HM-102  
Tiara\*  
pg. 34

HM-104  
Regency\*  
pg. 34

HM-106  
Classic\*  
pg. 35

HM-128  
Graceland\*  
pg. 35

Not available with Arch Top

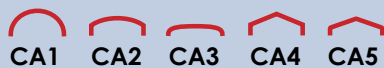

\* Not available in zinc plating for shoreline



## TRADITIONAL SERIES



pg. 36



pg. 36

HM-124 Caribbean ▲

HM-125 Venice ▲

Not available with Arch Top



HM-123  
Chateau\*  
pg. 36



HM-123-R



HM-123-F

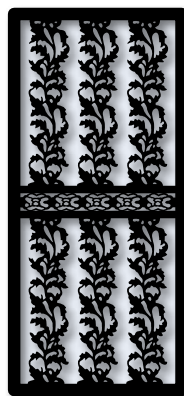

HM-124  
Caribbean\*  
pg. 36



HM-124-R



HM-124-F

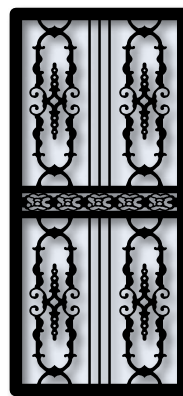

HM-125  
Venice\*  
pg. 36



HM-125-R



HM-125-F



HM-126  
Regal\*  
pg. 37



HM-126-R



HM-126-F

FOR MATCHING SIDELITES REFER TO PRICE BOOK



# TRADITIONAL SERIES

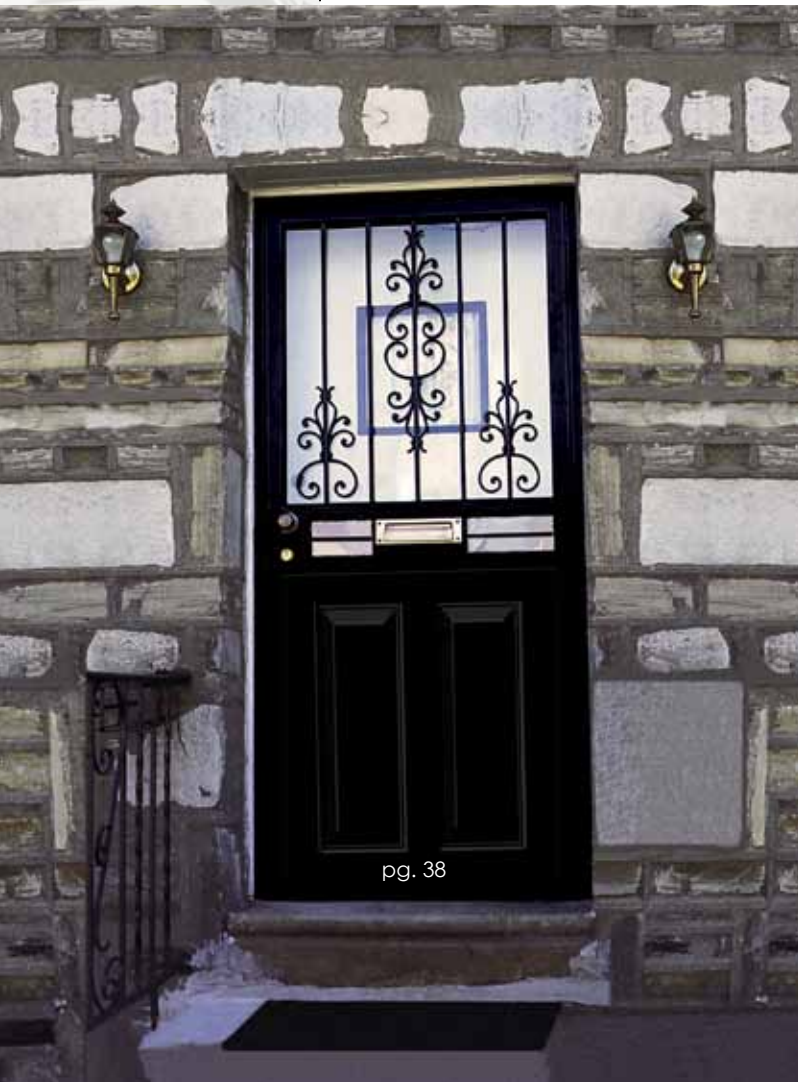

HM-138-R Mardi Gras ▲



HM-140 Bourbon ▲



HM-137-R



HM-137-F

HM-137  
Baton Rouge  
pg. 37

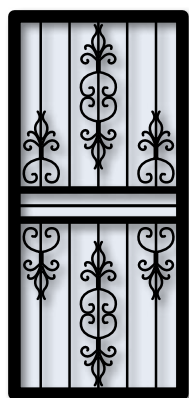

HM-138-R



HM-138-F

HM-138  
Mardi Gras  
pg. 38

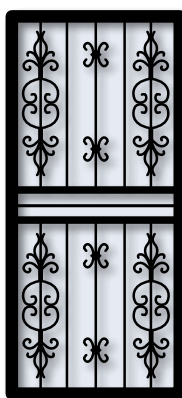

HM-139-R



HM-139-F

HM-139  
Maison  
pg. 38



HM-140-R



HM-140-F  
pg. 35

HM-140  
Bourbon  
pg. 38





HM-134 Sierra in a Patio Door Configuration ▲



HM-140-R Bourbon in a Double Door Configuration ▲

### PATIO DOORS

All SafeGuard™ security doors are available in patio doors.

This is the recommended patio configuration. The stationary door is inactive and can be opened to allow easy access for cleaning.

Upon request the stationary door can come without hinges or lock. It will be permanently fixed in place.



HM-133-R



HM-133-F

HM-133  
Sparta  
pg. 39

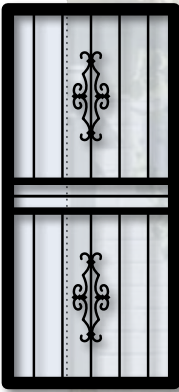

HM-134-R



HM-134-F

HM-134  
Sierra  
pg. 39

### DOUBLE DOORS

All SafeGuard™ security doors are available in double door configuration.

Each door operates independently of the other.

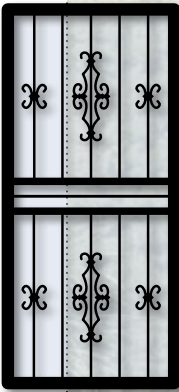

HM-135-R



HM-135-F

HM-135  
Matterhorn  
pg. 40

# VALUE LINE SERIES

SafeGuard™ value line doors have the same high quality and level of security as our premium doors. The difference is in the design. Value line doors have a more simplistic, economical design.

The value line series is only available with an economy #4 lever.

*Note: Value Line Series doors are not available with a mailslot.*



HME-147 Cannes ▼

Economy #4

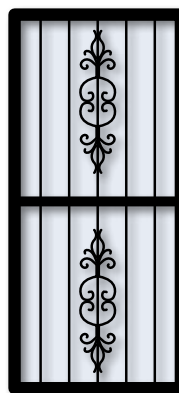

**HME-142**

Savannah  
pg. 40

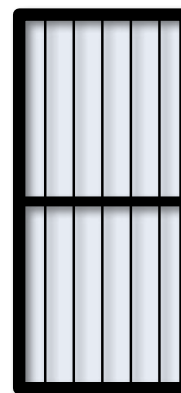

**HME-145**

Washington  
pg. 41



**HME-143**

Columbia  
pg. 40

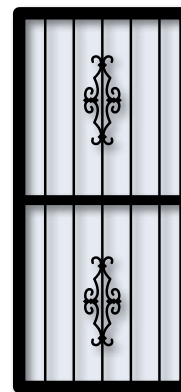

**HME-146**

Paris  
pg. 41

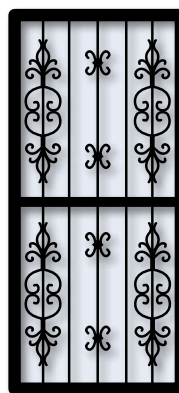

**HME-144**

Richmond  
pg. 40

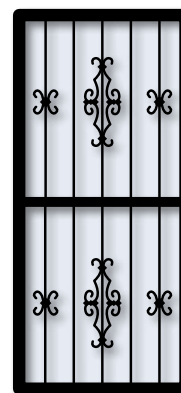

**HME-147**

Cannes  
pg. 41



pg. 41



*Note: Value Line Series Doors are not available with mailslot.*



## ARCH TOP OPTIONS



HMI's Arch Top Doors are available in 5 shapes. Homeowners can choose the shape that fits their architectural needs. Each arch top door is custom made. All doors are marked with the arch tops available for that style.

## SECURITY STORM FEATURES

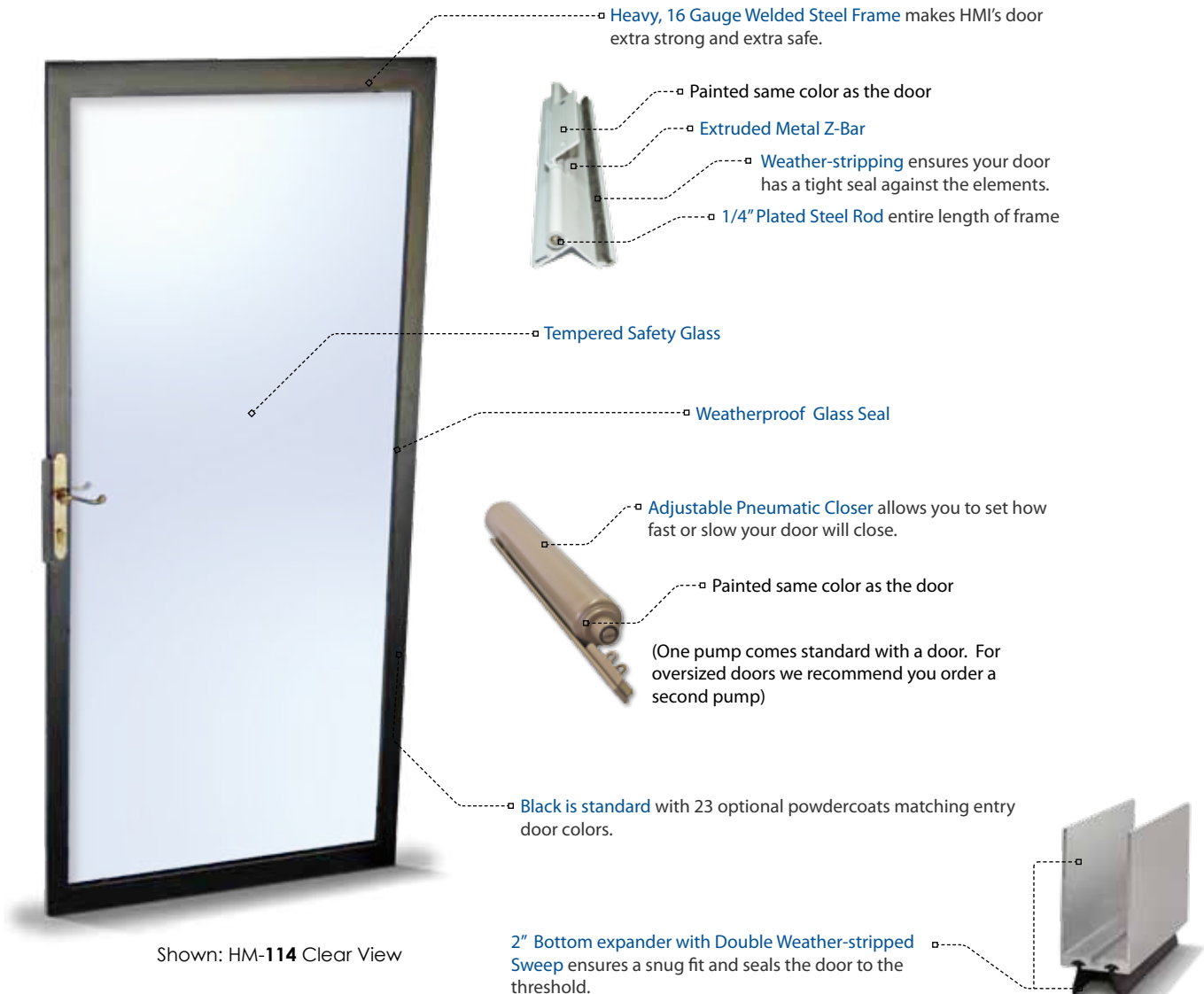

# ALUMINUM STORM DOOR LOCK OPTIONS

Refer to index for measurements

## PULL HANDLES Single Cylinder Only



Single Cylinder  
Interior Deadbolt #6



Interior Push Handle #6

#6



Optional Kick Plate

3" Bottom Aluminum Expander  
Painted to match your storm door  
 - Optional Outside Only

## SCULPTED LEVERS Single Cylinder Only

Left Hinge Out Swing Door

Right Hinge Out Swing Door



#7



#7



Single Cylinder  
Interior Deadbolt #7



Interior Push Handle #7

## ELITE LEVERS Single Cylinder Only



#8



## MORTISE LOCK Available in Double or Single Cylinder



Slimline Lock #9



## MAIL SLOT OPTIONS - FOR ALUMINUM AND SECURITY DOORS

HMI offers double flap mail slots in four different finishes to match your choice of handleset. US Postal regulations require mail slots to be no less than 30" from the ground.



Polished Brass



Antique Brass

Mail Slot 3 x 10 - 



Satin Nickel

Magazine Slot 3 1/2 x 13 - 



Aged Bronze



# SECURITY STORM DOOR LOCK OPTIONS

Refer to index for measurements



## ALUMINUM & SECURITY HARDWARE OPTIONS



2" Bottom Aluminum Expander  
Painted to match security storm door  
Optional Outside Only



Door Closers are painted to match your Aluminum and Security Storm Door finish.

For Security  
Doors Only  
Inside View



Double Cylinder - Standard  
Keyed Exterior & Interior

Single Cylinder - Optional  
Keyed Exterior & Thumb  
Turn Interior

## POWDERCOAT FINISHES

All Aluminum and Security Storm doors manufactured by HMI are coated with a "state-of-the-art" powdercoat finish to give years of trouble free enjoyment. The metal is cleaned and treated with chemically balanced detergents; The doors are then top coated with a powdercoating that is electrostatically applied and finally baked at 400° offering excellent adhesion, hardness, chemical resistance and weather resistance.



In addition to the 25 standard powdercoat finishes, HMI offers over 200 Custom Powdercoat Finishes. Please consult your local dealer for details.

Note: These sample colors do not accurately reflect actual painted surface color. For closer accuracy please use HMI Color Chips or refer to the HMI Color Guide.



Indicates that lock can be keyed to entry door lock



Indicates that lock cannot be keyed to entry door lock



BE SURE TO ALSO LOOK AT OUR  
**ENTRY DOOR CATALOG**



Distributed by:

A large white rectangular box intended for a distributor's name or address.



PROUDLY MADE IN THE U.S.A.

[www.hmidoors.com](http://www.hmidoors.com)  
Copyright © 2018 Household Metals, Inc.